

PCV Hose Assembly

EMISSION CONTROL (AUX. EMISSION CONTROL DEVICES)

10.PCV Hose Assembly

A: REMOVAL

CAUTION:

Do not remove unless the hose and the diagnostics connector are broken.

- 1) Disconnect the connector (A) from the PCV hose assembly A.
- 2) Remove the PCV hose assembly A from the clip (B), and remove the PCV hose assembly A from the PCV pipe.

NOTE:

Pinch the clamp of the PCV hose assembly A by fitting the cut out in the ST with the protrusion on the clamp as shown in the figure, and unlock the clamp.

ST 18353AA000 CLAMP PLIERS

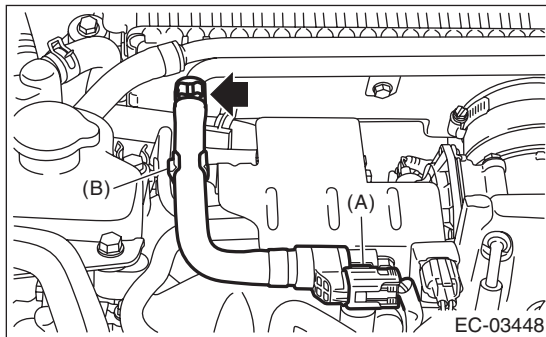
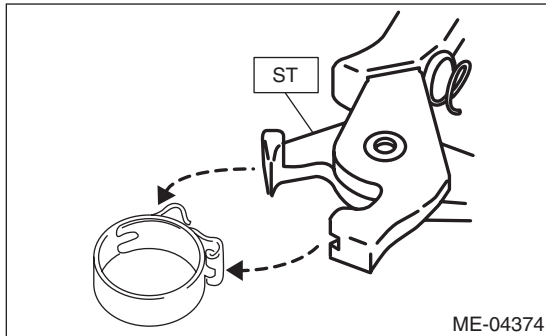

- 3) Remove the connector from the PCV hose assembly B.

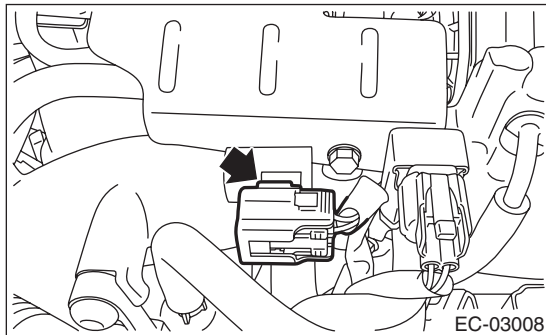

- 4) Remove the PCV hose assembly B from the intake duct.

NOTE:

Pinch the clamp of the PCV hose assembly B by fitting the cut out in the ST with the protrusion on the clamp as shown in the figure, and unlock the clamp.

ST 18353AA000 CLAMP PLIERS

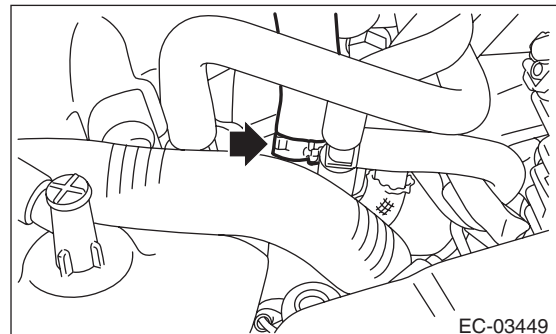
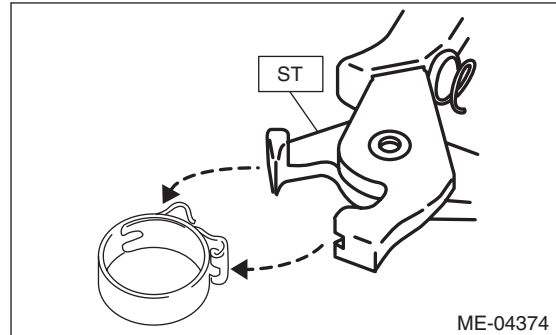

- 5) Remove the intake manifold. <Ref. to FU(STI)-17, REMOVAL, Intake Manifold.>
- 6) Remove the turbocharger. <Ref. to IN(STI)-16, REMOVAL, Turbocharger.>

PCV Hose Assembly

EMISSION CONTROL (AUX. EMISSION CONTROL DEVICES)

7) Remove the PCV hose assembly C from the cylinder block RH.

NOTE:

Pinch the clamp of the PCV hose assembly C by fitting the cut out in the ST with the protrusion on the clamp as shown in the figure, and unlock the clamp.

ST 18353AA000 CLAMP PLIERS

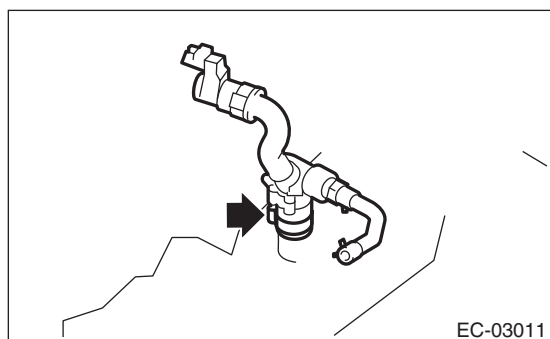
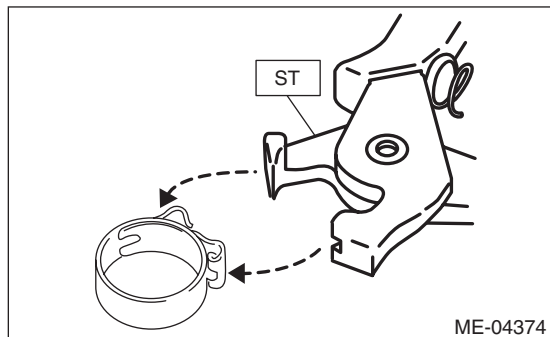

B: INSTALLATION

1) Install the PCV hose assembly C onto the cylinder block RH.

NOTE:

Use a new clamp for the PCV hose assembly C, fit the cut out in the ST with the protrusion on the clamp as shown in the figure, and lock the clamp.

ST 18353AA000 CLAMP PLIERS

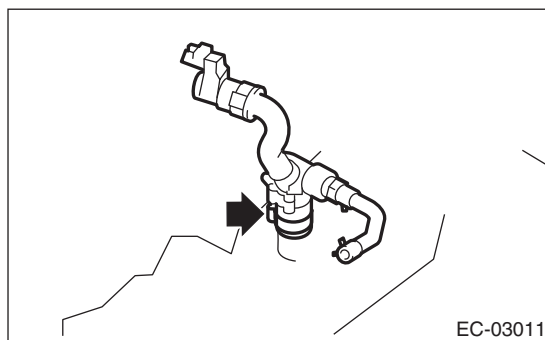
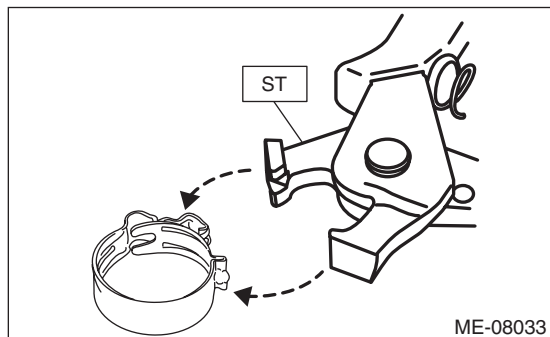

2) Install the turbocharger. <Ref. to IN(STI)-17, INSTALLATION, Turbocharger.>

3) Install the intake manifold. <Ref. to FU(STI)-21, INSTALLATION, Intake Manifold.>

4) Install the PCV hose assembly B onto the intake duct.

NOTE:

Use a new clamp for the PCV hose assembly B, fit the cut out in the ST with the protrusion on the clamp as shown in the figure, and lock the clamp.

ST 18353AA000 CLAMP PLIERS

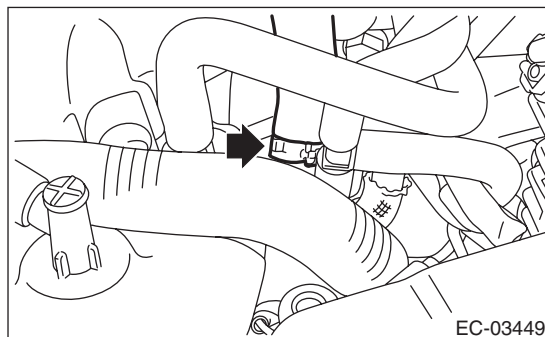
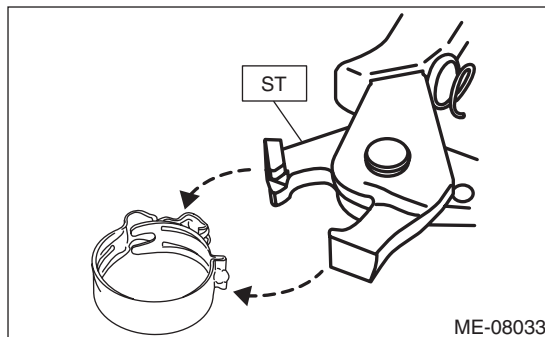

5) Connect the connector to the PCV hose assembly B.



PCV Hose Assembly

EMISSION CONTROL (AUX. EMISSION CONTROL DEVICES)

6) Install the PCV hose assembly A to the PCV pipe, and install the PCV hose assembly A to the clip (B).

NOTE:

Use a new clamp for the PCV hose assembly A, fit the cut out in the ST with the protrusion on the clamp as shown in the figure, and lock the clamp.

ST 18353AA000 CLAMP PLIERS

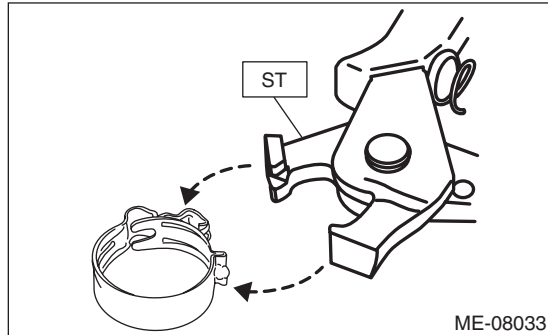

7) Connect the connector (A) to the PCV hose assembly A.

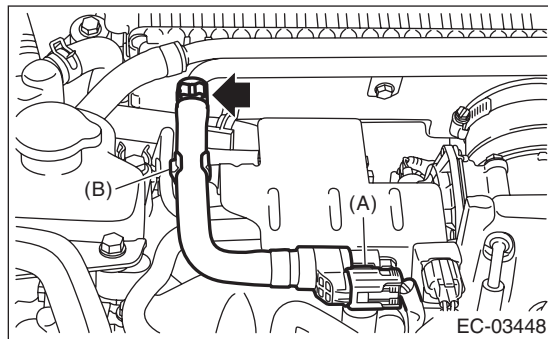

C: INSPECTION

1. DIAGNOSIS CONNECTOR

1) Check that the diagnosis connector has no deformation, cracks and any other damage.

2) Check the resistance between the diagnosis connector terminals.

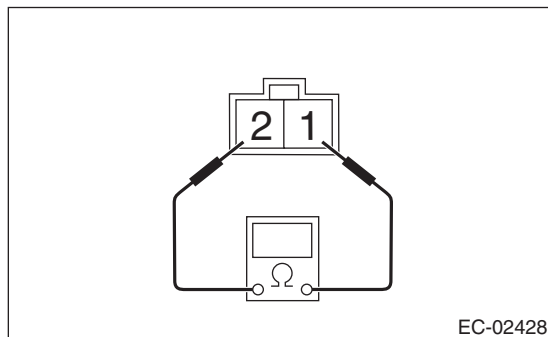

Terminal No.	Standard
1 and 2	Less than 1 Ω

2. OTHER INSPECTIONS

1) Check that the PCV connector has no deformation, cracks or other damages.

2) Check that the hose has no cracks, damage or loose part.